

Description as furnished:

All that part of the N 1/2 of the NE 1/4 of Section 24, T6N, R11W, City of Kentwood, Kent County, Michigan, described as: Commencing at the N 1/4 corner of said Section; thence East 700.0 feet along the North line of said Section to the Place of Beginning of this description; thence East 443.8 feet along the North line of said Section to a point that is 1501.91 feet West along the North line of said Section from the NE corner of said Section; thence South perpendicular to said Section line 619.02 feet to a line that is 660.0 feet North from and parallel with the North line of the Chesapeake & Ohio Railway R.O.W. (100 feet wide); thence S89°57'W 443.8 feet along said line to a line bearing South perpendicular from the place of beginning of this description; thence North 619.41 feet to the point of beginning. EXCEPT the North 50 feet thereof.

ALSO EXCEPT that part of the NE 1/4 of Section 24, T6N, R11W, City of Kentwood, Kent County, Michigan, described as: Beginning at a point on the North line of Section 24, which is N90°00'E 943.8 feet from the N 1/4 corner of Section 24; thence N90°00'E 200.0 feet along said North line to a point which is 1501.91 feet West of the NE corner of Section 24; thence S00°00'W 619.02 feet; thence S89°57'W 443.8 feet along a line which is 660 feet Northerly from and parallel with the North line of the C&O Railroad R.O.W.; thence N00°00'E 153.41 feet; thence N90°00'E 280.0 feet; thence N00°00'E 316.0 feet; thence S90°00'W 36.2 feet; thence N00°00'E 150.0 feet to the place of beginning.

AND ALSO EXCEPT that part of the NE 1/4 of Section 24, T6N, R11W, City of Kentwood, Kent County, Michigan, described as: Commencing at the N 1/4 corner of Section 24; thence N90°00'E 700.00 feet along the North line of said NE 1/4; thence S00°00'W 264.50 feet to the Place of Beginning of this description; thence S90°00'E 7.00 feet; thence S00°00'W 230.00 feet; thence N90°00'W 7.00 feet; thence N00°00'E 230.00 feet to the place of beginning, EXCEPT the South 28.5 feet thereof.

SURVEYOR'S CERTIFICATE

With respect to this survey, the undersigned, a registered land surveyor, in and for the state of Michigan, hereby certifies as follows to (a) CalEast NAT, LLC, CalEast Industrial Investors, LLC, LaSalle Investment Management, Inc.; their respective lenders, partners, subsidiaries, and affiliates, and their respective successors and assigns, (b) Chicago Title Insurance Company, each of whom may rely on this certification:

That this map or plat and the survey on which it is based were made in accordance with the "Minimum Standard Detail Requirements for ALTA/ACSM Land Title Surveys", jointly established and adopted by ALTA and NSPS in 2005, and includes Items 1, 4, 7(a), 8 and 10 of Table A thereof. Pursuant to the Accuracy Standards as adopted by ALTA and NSPS and in effect on the date of this certification, undersigned further certifies that in my professional opinion, as a land surveyor in the State of Michigan, the Relative Positional Accuracy of this survey does not exceed that which is specified therein.

June 12, 2007

Douglas J. Root, P.S. 41109

Notes:

1. The bearings shown hereon are the North line of Section 24 = N90°00'E, as recited in the description of the premises.
2. Legal description is based on Chicago Title Insurance Company Commitment No. 20701543, dated June 4, 2007.
3. This parcel contains 2.56 acres.

L:\071540\dwg\071540.dwg

**ALTA/ACSM LAND TITLE SURVEY**

FOR: MR. JAMES C. GODEY, ESQUIRE RE: 4530 - 36TH ST.  
 AEROTERM/NORTH AMERICAN TERMINALS  
 ANNAPOLIS, MARYLAND 21401  
 IN: PART OF THE NE 1/4, SECTION 24, T6N, R11W,  
 CITY OF KENTWOOD, KENT COUNTY, MICHIGAN

REVISIONS:			<b>exxel engineering inc.</b> 5252 CLYDE PARK, S.W. • GRAND RAPIDS, MI. 49509 PHONE (616) 531-3660 FAX (616) 531-2121
DRAWN BY:	JJS		
APPROVED BY:	DJR	DATE:	6/14/07
		SHEET	1 OF 1

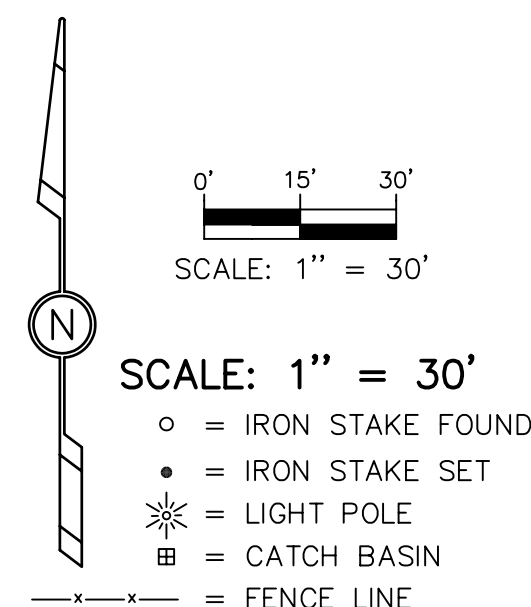

SCALE: 1" = 30'

- = IRON STAKE FOUND
- = IRON STAKE SET
- ☼ = LIGHT POLE
- ⊞ = CATCH BASIN
- x-x- = FENCE LINE